

# **Exmouth Pavilion Technical Specification**

**Revised 14<sup>th</sup> March 2023**

## **In-house Technicians:**

### **Robin Eagle (Technical Manager)**

**(Always best to send any info/requests direct to technical email address first)**

Email: [technical@ledleisure.co.uk](mailto:technical@ledleisure.co.uk)  
[reagle@ledleisure.co.uk](mailto:reagle@ledleisure.co.uk)

Please email or ring to confirm availability of any specific items or requirements

Phone: **(01395) 222 477**

## **Access**

Stage: Via double height roller shutter door SR – up steps on to stage or 4000mm x 1000mm loading ramp to provide slope onto stage or for use between stage and pavement or a truck or van.

(In summary we can move flight cases out the back of parked van to stage level via ramp, or from road level)

Distance from loading bay door to edge pavement 3,600mm, then 3,000mm further to edge road so a vehicle 6,600mm long or longer van will start to encroach into live carriageway.

We do have some plastic warning barriers to help divert pedestrians round front of a van during the load in, any longer vehicles will best be parked on the road at 90 degrees to loading bay and above ramp used to wheel kit up on to stage level from ground level, this can best be resolved on the day.

NB auditorium access level matches street level through double doors to auditorium 2,030mm x 1,470mm

Disabled access lift (250kg Maximum SWL) ground level to stage level.

## **Parking**

### **REFER ALSO TO ACCESS section above**

Pay and Display parking is available at **The Beach Gardens Car Park**, Chargeable from 8am to 6pm.

Pay and Display parking available along the sea front, chargeable from 8am to 6pm

Restricted onsite parking is available by prior arrangement for a few cars.

There is NO available parking for HGV vehicles/coaches overnight within our boundaries, smaller transit/sprinter spaces are available direct on to the loading bay or adjacent next to bin store

## **Dressing Rooms**

Ground floor dressing room with shower and WC

Large male dressing room on first floor with showers and WC

Large female dressing room on first floor with showers and WC

Disabled dressing room with shower and WC on ground floor, please advise in advance if required.

Additional space in basement for make-up/wardrobe or as an additional dressing room, please advise in advance if required.

### **Additional Facilities Available in dressing rooms**

Tea, Coffee making facilities

Small Fridge

Ironing Facilities

Microwave

Laundry Facilities may be available. Please enquire at time of arrival

## **Fire Exits – (MUST NOT BE BLOCKED)**

### **Hall**

- 3 double fire exits on the left (sea side)
- 2 double fire exits on the right (back of hall)
- 2 fire exits at the rear (via entrance lobby, then to sea front)

### **Stage & dressing rooms**

- 1 fire exit SR, via electric (battery backup) load in roller shutter.
  - 1 exit route via pass door SL
  - 1 fire exit from dressing rooms (via basement)
  - 1 fire exit from Fly Floor (to upstairs dressing rooms, then down to basement)
  - 1 fire exit from Control Tower
- Fire Exits must be kept clear, and un-obstructed at all times. (this includes Get-ins and outs) excluding load in door until time of show.

### **Cloths**

- Black pleated Back-Cloth c/w fibre optic star curtain, (Height:5500mm, Width:8400mm, against rear wall)
- White cyclorama cloth (Height:5500mm, Width:8000mm) **PLEASE ADVISE IN ADVANCE IF REQUIRED**
- Black Stage border x3
- Black Stage legs x4
- Terracotta house tabs operated via **manual pulley SL**
- Black half tabs operated via **manual pulley SL**
- Fire safety curtain operated SL

### **Flying**

#### **Access Equipment**

- Vertical ladder to fly-floor and perch SL
- Vertical ladder to perch SR
- Vertical ladder (shorter) to fly floor accessed from upstairs landing adjacent to upper dressing rooms.
- Zarges (12 rung) Tall A-frame ladder for on stage use
- Push around GENIE for access in hall – to be used by IPAF qualified personnel only

#### **Bars**

- 8 Manual hemp flying bars (not counterbalanced) (safe working load 50kg)
- 1 x Manual Chain hoist bar upstage under Fly Floor Gantry, rigged with star cloth (restricted use)
- 4 LX bars winch operated (manual) (safe working load 250kg)
- Vertical perch (side boom) bars SL & SR
- Flying height 5627mm
- Flying width 9400mm
- Grid Height 12237mm

## **Stage Dimensions**

### **Widths**

- Full stage width (including legs and wings): 11260mm
- Main Stage width (not including wings and legs): 6800mm
- Front apron width 11650mm
- Wing width 1100mm
- Leg width 1100mm
- (metres to feet is 1m = 3.28 ft)

### **Depths**

- Full stage depth (front of apron to back wall) 7684mm
- Apron depth 2150mm
- Main Stage depth (back wall to Iron) 5334mm
- Iron depth 200mm

**Effective performance area: 6.8m wide by 7.6m deep.**

**The Safety Curtain Line must be kept clear of any fixed or bulky items at all times.**

### **Proscenium Arch**

Width 8,600mm

Height (at centre) 4889mm

Height (at sides) 4463mm

### **Auditorium Dimensions**

Width 14,585mm

Depth 27,317mm

Height (Highest point) 6895mm

Height (Lowest Point) 5740mm

### **Stage Risers / Drum risers**

4x Prolyte Risers (2000mm x 1000mm with 300mm legs)

Deck Levellers

Deck Clamps

Additional risers and stage decking can be sourced on your behalf if required, with advanced notice!

## **Power**

Supply on stage (SL):

**63amp three phase** Cee form socket

**63amp single phase** Cee form socket

**32amp single phase** Cee form socket

**32amp single phase** Cee form socket– sound phase

Sound phase: 13amp double sockets USL & USR

General power: 13 amp double sockets on all corners of stage

Sound phase: 32amp single phase cee form socket under stage area (basement level, used for in house amp rack)

**Exmouth Pavilion does NOT have 16amp power outlets. We do however carry a small stock of 16amp cable and a few adapters. HOT power off various stage boxes is on 15amp sockets, again we have a few adapters but always check in advance any specific requirements.**

## **Lighting**

### **Basic**

*Standard Parcan Par64 rig giving 4 colour washes (rig diagram available) + specials and basic intelligent lighting.*

**Control** (located in tech tower at back of hall)

**Grand MA Dot2** – 4,096 dmx channels.

ALL house lighting operated on universe 1, universe splitter is under stage with various patch outlets about stage and FOH lighting grid.

1x ELC Focus Brain

***A second DMX universe for additional and toured lighting is available upon request. We do not have a CAT5 run in place for external company use, yet.***

### **Dimming and Patching**

72 x 10A permanent dimming channels – zero 88 Chilli Pro dimmers

1 x DMX splitter/buffer – distribution for stage facility panels – Patchable

4 on stage lighting bars IWB on winch sets (all sockets are 15A)

12 circuits on LX 1, 2 & 3. - 6 circuits on LX4

**(LX 1** circuits 21 to 32, **LX 2** circuits 33 to 44, **LX 3** circuits 45 to 56, **LX 4** circuits 57 to 62)

4 paired circuits on SL and SR perch level (circuits 63 to 66)

Perch's: 3154mm above stage

2 FOH lighting bars SR & SL linked in parallel with 4x hard power and DMX (circuits 13 to 20)

2 FOH lighting bar across auditorium linked in parallel with 1x hard power (the only 13amp outlet!) (circuits 1 to 12)

Facility Panels on corners of stage with 6 dimmer channels 15A, Hard power 15A & 13A, and DMX (circuits 66 to 72)

1x Pulsar Chromazone 6way LED controller (dedicated FOH side uplights only)

For info, FOH lights manual control BUT can also be patched to show file as dimmers 501 through to 510

## **Cables and accessories**

20 x 15A Grelcos, assortment of 13A/15A/DMX cables etc.

## **Lanterns (ongoing servicing and maintenance not all may be available on the day, please discuss in advance specific**

2x Strand CSI Follow Spots fitted with G22 1000w CSI lamps in control tower to rear of auditorium.

32 x Black Longnose Par64 (CP62) - *mainly by Thomas Engineering*

Above used and rigged as general 4 colour wash over main stage area (R, A, B + G)

4 x Black Longnose Par64 (CP62) stored loose

6 x Black floor Par64 cans shortnose (CP62) stored loose

5 x Strand SL – 15/32 profile (gobo size B) (650w each)

3 x Selecon Acclaim 18/34 profile (gobo size M) (600w each)

1 x Source 4 26 deg (gobo size A/B) (575w)

2 x Harmony PC (1200w each)

2 x Harmony F (1200w each)

6 x Starlette Fresnels (1000w each)

2 x Cantata Fresnels (1000w each)

5 x Quartet Fresnels (650w each)

2 x Prelude Fresnels (650w each)

Nearly all PC or F lanterns have barn doors

8 x 500w halogen floodlights – 15A plugs stored loose

4 x Showtec Phantom LED 50 Spot (sometimes rigged, check first, otherwise stored loose)

6 x ADJ LED Panels stored loose

4x BeamZ BT300 RGBW (sometimes rigged, check first, otherwise stored loose)

1 x Small Mirror ball and Medium speed motor – rigged centre FOH

(28 x Installed Pulsar Chroma Search LED fixtures. Permanently rigged in auditorium, secured as uprights)

**We also have some other lights available which may be rigged for use on the day, as well as good links with local lighting suppliers, so any specific effect or requirement can be accommodated at a reasonable cost, but please as always ask in advance. Just because “X” was in rig before does not mean it will be here next visit!**

## **Video Projection**

Vivitek DX977-WT 6000 ANSI Lumens XGA (1024x768) 4:3

Unicol PSU mount - 500mm tube – Scaffolding bar mount.

Medium throw with zoom

VGA to Stage Left

VGA, composite, component running to control tower

HDMI to Stage Left

HDMI from control tower

## **Cables**

1 x 10m VGA extension

2 x short VGA leads

## **Audio**

### **Please Note:**

**We have a strict limit of 103 decibels on all Sound within the venue however this can be reduced if the management deem it necessary.**  
**if this policy is not adhered to the venue management can and will terminate the performance.**

## **Mixer & control (located in tech tower at back of hall)**

1 x Allen & Heath QU-32 (Digital Console) c/w iPad remote

32 cable runs to SL and SR, amp rack, monitor feeds etc

**NB - IF we relocate mix position to floor level, in front of raised seating, then we run digital to two number stage boxes, Allen & Heath AB168 Audioracks via Cat5 link. At the moment we can NOT run the AB168's from the tower mix.**

1 x Numark Twin CD player

1 x Hearing aid induction loop

### **Speakers and Drive Rack**

2 x Martin Audio S218 sub bass speakers FOH floor- standing  
4 x Martin Audio F15+ cabinets flown FOH (Stereo L&R)  
4 x Martin Audio LE400 15" Monitor Wedge (4 circuits monitoring, more possible but needs additional signal runs)  
**NB – Again, if mix moved to floor level and we go digital, we can do more than 4 circuits monitoring but within the limits of the sound desk!**  
2x Thomann "the box pro" Achat 206 full range speakers (delay, installed for raised seating off matrix)  
2x RCF Art 708a 8" front fills (can be used)  
2 x FBT 12" 400w powered speakers (additional monitors if needed)  
1 x DBX Driverack PA speaker Management controlling MC2 amps in basement

### **Microphones**

2 x EW145 Sennheiser G3 hand held radio microphone and receivers  
2 x SM58 Shure Vocal  
1 x SM86 Shure Vocal  
6 x SM57 Shure Vocal / Instrument  
4 x Beta57 Shure Vocal / Instrument  
1 x PGA57 Shure instrument mic  
1 x Beta91 Shure Kick Drum  
1 x PGA 52 Shure kick drum mic  
2 x E614 Sennheiser Overhead  
2 x PGA 81 Shure Overhead  
4 x E604 Sennheiser Rack Tom c/w drum mounts  
4 x PGA 56 Shure drum mic c/w drum mounts  
5 x BSS Audio AR-133 Active DI box  
2 x Orchid Electronics DI box  
Additional mics available locally, specific requests can be quoted for direct.

### **Stands**

5 x KAM tall black microphone stands (c/w booms)  
5 x KAM short black microphone stand (c/w booms)  
3 hand adjustable gas round bottomed upright microphone stands  
3 x fixed black round bottomed upright microphone stands  
3 x additional tall black stands c/w booms, older, in reserve  
5 x additional short black stands c/w booms, older, in reserve  
2 x unlit music stands  
(10 x Orchestra stands c/w lights available BUT for additional fee as not ours)  
1 x Lectern (usually at SL prompt corner)

### **Patching & cables**

1x 24 + 8 return channel multicore (running between tower and under stage)  
2x VDC 12way stage boxes SL & SR running to under stage patch  
4 x XLR Tie lines on stage for alternative patching 2 Male 3pin, 2 Female 3pin  
1x Stock Assortment of cables, XLR 10m+5m, Speakon, jack, jumpers etc

### **Instruments**

1x Yamaha GT10 upright electric piano NO PIANO STOOL, but if required we can possibly acquire one in advance.

## **Communications**

5-way communications system (Canford Audio)  
5x belt packs  
single-muff headsets available  
double-muff headsets available  
Plug-in sockets on stage left, stage right, fly floor and control position

Tannoy system to – foyer/bar, and backstage dressing rooms.  
Call points – on stage SL (prompt corner) and office area

The Pavilion has an installed multi zone fire alarm, with call points. Mostly heat detectors used in performance areas – permitting the use of haze and smoke.  
No haze or smoke to be used in other areas, HOWEVER We must disable some additional smoke detectors in the performance area FIRST!

## Stage effects

1x Le Maitre Neutron XS Hazer – DMX control (currently addressed as circuit DMX ch 140)

Black Fibre Optic Star Cloth (Height:5500mm, Width:8000mm) (currently addressed as circuit DMX ch 57)

### Staffing Costs (correct as on 14<sup>th</sup> March 2023)

All Split contracts include Technical Support **free of charge for 8 Hours, then will be charged £24 per hour, per person.**

All Hire contracts will be charged for all Technical Staff, including any pre-rig requirements.

Technical Staff charges as below:

Duty House Technician **£24 per hour** (minimum 4 hour call)

Additional Techs for Lighting/Sound **£24 per hour** (minimum 4 hour call)

Followspot Operators/Fly/Stage Crew **£24 per hour** (minimum 4 hour call)

Load in, and load out crew **£24 per hour** (Minimum Call of 4 hours in total)

#### **Please note:**

- Any equipment being brought into the premises must be in a safe condition. We may request to see PAT test certificates or conduct a visual inspection at any time. The management reserves the right to refuse any equipment being used if thought to be unsafe in anyway.
- This technical specification should be used as a guide only. The Pavilion does not guarantee the availability of any of the items listed. If you specifically require the use of any of the equipment, prior notification must be given.
- No fire or pyrotechnics to be used during a performance without prior authorisation from the Technical Manager.
- It is **illegal** to smoke anywhere in the building.
- Fire exits must be kept clear at **all** times.
- Only water in plastic bottles maybe taken onto the stage.
- **The management reserves the right to control the Sound Pressure Levels of any event. Our SPL limit guideline is 103dBA, but be aware this is only a guide - If a request to reduce the Sound pressure Level at anytime is not adhered to, the management reserves the right to terminate the event and all loss of profits or costs incurred must be covered by the promoter/artist**

### Additional Technical Equipment for hire

Audio/Staging/Lighting/Communications/Pyrotechnics/Effects/AV/Scenery

We are able to source all sorts of equipment and crew, if there is anything missing from the above list that you require then please contact the Technical Crew who can assist you in acquiring the equipment you need, well in advance!

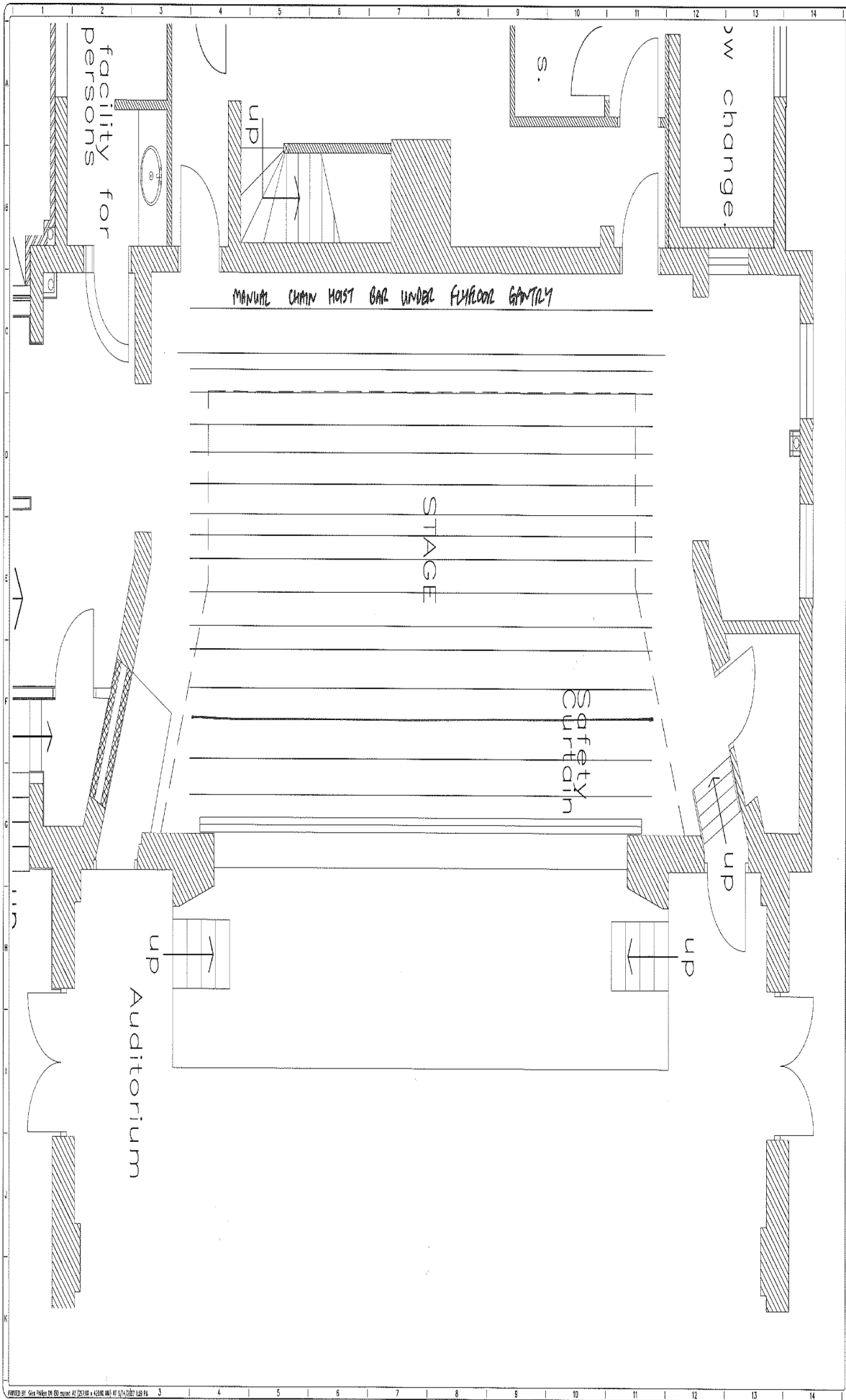

DO NOT SCALE A3

NOTES: 2015

- FULL BLACKS
- 13 HEMP
- 12 HEMP
- 11 WINCH
- 10 WINCH - LX
- 9 WINCH
- 8 HEMP
- 7 HEMP
- 6 HEMP
- 5 WINCH - LX
- 4 HEMP
- 3 HEMP
- 2 WINCH - BLACK TABS
- HEMP
- 1 WINCH - LX
- HOUSE TABS

INFORMATION

PROJECT		EXMOUTH PAVILION	
SERVICES		PRODUCTION SERVICES	
DRAWING TITLE		EXMOUTH PAVILION	
DRAWING NO.		EXMOUTH PAVILION	
SCALE		STAGE PLAN	
DATE	14.09.07	DRAWN BY	EXG
SCALE	1:50	CHECKED BY	

**STAGE ELECTRICS**  
 1000 New Avenue, Bristol, BS1 3PL  
 Tel: 0117 333 8888 Fax: 0117 333 8889  
 © 2007 Stage Electrics. All rights reserved. No part of this publication may be reproduced without the prior written permission of Stage Electrics.  
 www.stage-electrics.co.uk

# Grid Plan Existing

Last revised 12/03/23 by RSE

Currently rigged as	ref	SWL (kg)	offset (mm) from rear stage
fibre optic star cloth	<b>CH1</b>	restricted	<b>200</b>
White CYC cloth	<b>H8</b>	<b>50</b>	<b>850</b>
spare	<b>H7</b>	<b>50</b>	<b>1,100</b>
LX 4 (6ch) + x2 set legs	<b>W7</b>	<b>250</b>	<b>1,420</b>
LX 3	<b>W6</b>	<b>250</b>	<b>1,700</b>
spare	<b>W5</b>	<b>250</b>	<b>2,010</b>
spare	<b>H6</b>	<b>50</b>	<b>2,320</b>
x2 set legs	<b>H5</b>	<b>50</b>	<b>2,560</b>
border	<b>H4</b>	<b>50</b>	<b>2,780</b>
LX 2	<b>W4</b>	<b>250</b>	<b>3,120</b>
spare	<b>H3</b>	<b>50</b>	<b>3,480</b>
border	<b>H2</b>	<b>50</b>	<b>3,720</b>
black half tabs on track	<b>W3</b>	<b>250</b>	<b>4,010</b>
cinema screen	<b>H1</b>	<b>50</b>	<b>4,250</b>
LX 1	<b>W2</b>	<b>250</b>	<b>4,770</b>
fixed bar (normally house tabs)	<b>tabs</b>	restricted	<b>5,010</b>
border just behind Safety Curtain	<b>W1</b>	<b>250</b>	<b>5,140</b>
SAFETY CURTAIN	<b>SC</b>	n/a	<b>5,300</b>
Front of Stage (Thrust)			<b>7,600</b>
<b>Auditorium</b>			
lighting bar (fixed)	<b>FOH 2</b>	<b>150</b>	<b>9,265</b>
	<b>(FOH side x2)</b>	<b>100</b>	<b>9,265 to 14,270</b>
lighting bar (fixed)	<b>FOH 1</b>	<b>150</b>	<b>14,270</b>

**CH** = chain hoist    **W** = (manual) winch    **H** = hemp



